

# SPK

Installation and operating instructions



# English (GB) Installation and operating instructions

## Original installation and operating instructions

These installation and operating instructions describe Grundfos SPK pumps.

Sections 1-3 give the information necessary to be able to unpack, install and start up the product in a safe way.

Sections 4-9 give important information about the product, as well as information on service, fault finding and disposal of the product.

## CONTENTS

	Page
<b>1. General information</b>	<b>2</b>
1.1 Hazard statements	2
1.2 Notes	2
<b>2. Installing the product</b>	<b>3</b>
2.1 Mechanical installation	3
2.2 Electrical connection	4
<b>3. Starting up the product</b>	<b>4</b>
<b>4. Product introduction</b>	<b>5</b>
4.1 Applications	5
4.2 Identification	5
4.3 Pump key	5
<b>5. Servicing the product</b>	<b>5</b>
5.1 Maintaining the product	5
5.2 Contaminated products	6
<b>6. Taking the product out of operation</b>	<b>6</b>
6.1 Taking the product permanently out of operation	6
<b>7. Technical data</b>	<b>6</b>
7.1 Sound pressure level	6
<b>8. Fault finding the product</b>	<b>7</b>
<b>9. Disposing of the product</b>	<b>8</b>



Read this document before installing the product. Installation and operation must comply with local regulations and accepted codes of good practice.

## 1. General information

### 1.1 Hazard statements

The symbols and hazard statements below may appear in Grundfos installation and operating instructions, safety instructions and service instructions.



#### DANGER

Indicates a hazardous situation which, if not avoided, will result in death or serious personal injury.

#### WARNING



Indicates a hazardous situation which, if not avoided, could result in death or serious personal injury.

#### CAUTION



Indicates a hazardous situation which, if not avoided, could result in minor or moderate personal injury.

The hazard statements are structured in the following way:

#### SIGNAL WORD



##### Description of hazard

Consequence of ignoring the warning.  
- Action to avoid the hazard.

#### 1.2 Notes

The symbols and notes below may appear in Grundfos installation and operating instructions, safety instructions and service instructions.



Observe these instructions for explosion-proof products.



A blue or grey circle with a white graphical symbol indicates that an action must be taken.



A red or grey circle with a diagonal bar, possibly with a black graphical symbol, indicates that an action must not be taken or must be stopped.



If these instructions are not observed, it may result in malfunction or damage to the equipment.



Tips and advice that make the work easier.

## 2. Installing the product

### 2.1 Mechanical installation

#### WARNING

##### Moving parts

- Death or serious personal injury
- Tighten the coupling screws to the correct torque.
  - Install the coupling guards securely to the pump with the screws intended for this purpose.



#### CAUTION

##### Hot surface

- Minor or moderate personal injury
- The pump must be installed so that persons cannot accidentally come into contact with the hot surface of the motor.



#### 2.1.1 Pump location

The pump is designed for tank mounting in vertical position. The pump is positioned in a hole cut into the cover of the tank (upper side) and is secured to the tank by four hexagon head screws through the holes in the mounting flange. We recommend to fit a sealing gasket between the pump flange and tank. If the pump is to be installed horizontally, the drain hole of the motor stool must be fitted with a plug.

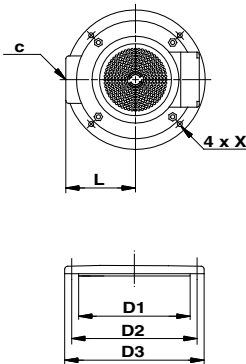

Fig. 1

Pump mounting flange dimensions:

Pump type	D1	D2	D3	L	C	X
SPK 1, 2 and 4	100	115	130	64	Rp 3/4	Ø7.5
SPK 8	140	160	180	100	Rp 1 1/4	Ø7.5

#### 2.1.2 Inlet conditions

The bottom of the pump strainer must be at least 25 mm above the bottom of the tank.

The pumps are designed to provide full performance down to a level of A mm above the bottom of the strainer.

At a liquid level between A and B mm above the bottom of the strainer, the built-in priming screw will protect the pump against dry running.

Pump type	A [mm]	B [mm]
SPK	40	25

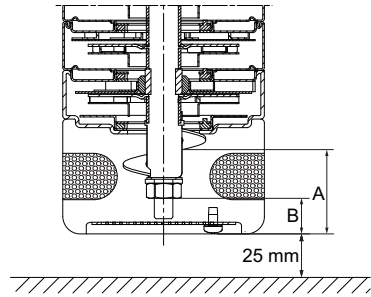

Fig. 2

TM07 2804 4118

TM00 4375 5298

## 2.2 Electrical connection

### WARNING

#### Electric shock

Death or serious personal injury

- Before starting any work on the product, make sure that the power supply has been switched off and that it cannot be accidentally switched on.
- Connect the pump to an external main switch close to the pump and to a motor-protective circuit breaker or a CUE frequency converter. Make sure you can lock the main switch in OFF position (isolated). Type and requirements as specified in EN 60204-1, 5.3.2.



The operating voltage and frequency are marked on the pump nameplate. Please make sure that the motor is suitable for the power supply on which it will be used.

Single-phase Grundfos motors incorporate a thermal overload switch and require no additional motor protection.

Three-phase motors must be connected to a motor starter.

The terminal box can be turned to four positions, in 90° steps, see fig. 3.

Proceed as follows:

1. Remove the coupling guards. Do *not* remove the coupling.
2. Remove the four bolts securing the motor to the motor stool.
3. Turn the motor to the required position.
4. Replace and tighten the four bolts.
5. Replace the coupling guards.

The electric motor must be connected to the supply as shown in the diagram inside the terminal box cover.

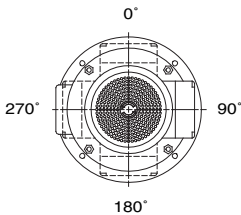

Fig. 3

TM00 4257 2294

## 3. Starting up the product

### WARNING

#### Too high pressure and leakage

Death or serious personal injury

- Do not run the pump against a closed outlet valve for more than approx. 5 minutes.



#### Before starting the pump, make sure:

- that all pipe connections are tight.
- that the pump body is partly filled with liquid (partly submerged).
- that the strainer is not blocked by impurities.

#### Start the pump as follows:

1. Close the isolating valve on the outlet side of the pump.
2. If the pump is fitted with a vent valve, this valve must be opened, see fig. 4.

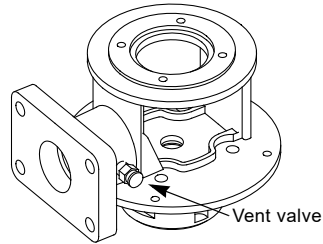

Fig. 4

3. See the correct direction of rotation of the pump on the motor fan cover. When seen from the top, the pump must rotate *counterclockwise*.
  4. Start the pump and check the direction of rotation.
  5. Open the outlet isolating valve a little.
  6. If the pump is fitted with a vent valve, this valve must be closed when a steady stream of liquid runs out of it.
  7. Completely open the outlet isolating valve.
- The pump has now been vented and is ready for operation.

TM01 6428 2399

## 4. Product introduction

### 4.1 Applications

The Grundfos pumps, type SPK, are multistage centrifugal pumps designed for pumping liquids for machine tools, condensate transfer, liquid transfer in industrial washing machines and similar applications.

#### WARNING



#### Fire and explosion

- Death or serious personal injury
- Do not use the pump for flammable, combustible or explosive liquids.

The pumps are designed for pumping liquids with a density and viscosity corresponding to those of water. The pumped liquid must not contain abrasive particles or fibres.

When pumping liquids with a density or viscosity higher than that of water, the motor size must be taken into consideration.

### 4.2 Identification

The standard range of pumps encompasses complete impeller-in-chamber combinations.

Depending on duty combinations, other lengths can on request be supplied by fitting empty intermediate chambers instead of standard chambers with impellers.

The pump key on the pump nameplate indicates the number of chambers and impellers fitted to the pump.

### 4.3 Pump key

Example	SPK 4 - 16 / 2 -x -x -x -xxxx
Pump range	SPK 4 - 16
Nominal flow rate in m <sup>3</sup> /h	16 / 2
Number of stages	2 -x
Number of impellers	-x -x
Code for pump version	-x -xxxx
Code for pipe connection	
Code for materials	
Code for shaft seal and rubber pump parts	

## 5. Servicing the product

### WARNING



#### Electric shock

- Death or serious personal injury
- Before starting any work on the product, make sure that the power supply has been switched off and that it cannot be accidentally switched on.

### WARNING



#### Moving parts

- Death or serious personal injury
- Tighten the coupling screws to the correct torque.
  - Install the coupling guards securely to the pump with the screws intended for this purpose.

### CAUTION



#### Corrosive liquids

- Death or serious personal injury
- Wear personal protective equipment.

### CAUTION



#### Toxic liquids

- Death or serious personal injury
- Wear personal protective equipment.



### CAUTION

#### Hot or cold liquid

- Minor or moderate personal injury
- Wear personal protective equipment.



### CAUTION



#### Hot or cold surface

- Minor or moderate personal injury
- Make sure that no one can accidentally come into contact with hot or cold surfaces.



### 5.1 Maintaining the product

Pumps installed in accordance with these instructions require very little maintenance.

The mechanical shaft seal is self-adjusting and has wear-resistant seal rings which are lubricated and cooled by the pumped liquid.

The pump bearings are also lubricated by the pumped liquid. The motor ball bearings are grease packed and sealed for life. No further lubrication is necessary.

Pumps from 4 kW and up have angular contact bearings.

### 5.1.1 Filters

Chip trays, filters, etc. must be cleaned at regular intervals to ensure a correct flow of liquid.

### 5.1.2 Periodic checks

At regular intervals, depending on the conditions and time of operation, the following checks should be made:

- Check the quantity of liquid and operating pressure.
- Check that there are no leaks.
- Check that the motor is not overheating.
- Check the tripping of the motor starter.
- Check that all controls are operating satisfactorily.

If the above checks do not reveal any abnormal operating details, no further checks are necessary.

Should any faults be found, check the symptoms with section [8. Fault finding the product](#).

## 5.2 Contaminated products

The product will be classified as contaminated if it has been used for a liquid which is injurious to health or toxic.

If you request Grundfos to service the product, contact Grundfos with details about the liquid before returning the product for service. Otherwise, Grundfos can refuse to accept the product for service.

Any application for service must include details about the liquid.

Clean the product in the best possible way before you return it.

Costs of returning the product are to be paid by the customer.

## 6. Taking the product out of operation

### 6.1 Taking the product permanently out of operation

#### CAUTION



#### Corrosive liquids

Death or serious personal injury  
- Wear personal protective equipment.

#### CAUTION



#### Toxic liquids

Death or serious personal injury  
- Wear personal protective equipment.

#### CAUTION



#### Hot or cold liquid

Minor or moderate personal injury  
- Wear personal protective equipment.



#### CAUTION



#### Hot or cold surface

Minor or moderate personal injury  
- Make sure that no one can accidentally come into contact with hot or cold surfaces.



## 7. Technical data

Pump type	SPK
Minimum liquid temperature [°C]	-10
Maximum liquid temperature [°C]	+90
Maximum ambient temperature [°C]	+40
Maximum operating pressure [bar]	10
Enclosure class	IP54

### 7.1 Sound pressure level

Motor [kW]	$\bar{L}_{pA}$ [dB(A)]	
	50 Hz	60 Hz
0.06	< 70	< 70
0.12	< 70	< 70
0.18	< 70	< 70
0.25	< 70	< 70
0.37	< 70	< 70
0.55	< 70	< 70
0.75	< 70	< 70
1.1	< 70	< 70
1.5	< 70	71
2.2	< 70	71

## 8. Fault finding the product

### WARNING

#### Electric shock



- Death or serious personal injury
- Before starting any work on the product, make sure that the power supply has been switched off and that it cannot be accidentally switched on.

### WARNING

#### Moving parts



- Death or serious personal injury
- Tighten the coupling screws to the correct torque.
  - Install the coupling guards securely to the pump with the screws intended for this purpose.

### CAUTION



#### Corrosive liquids

- Death or serious personal injury
- Wear personal protective equipment.

### CAUTION



#### Toxic liquids

- Death or serious personal injury
- Wear personal protective equipment.



### CAUTION

#### Hot or cold liquid

- Minor or moderate personal injury
- Wear personal protective equipment.



### CAUTION



#### Hot or cold surface

- Minor or moderate personal injury
- Make sure that no one can accidentally come into contact with hot or cold surfaces.



Fault	Cause	Remedy
1. Motor does not run when started.	a) Supply failure.	Connect the power supply.
	b) Fuses are blown.	Replace fuses.
	c) Motor starter overload has tripped.	Reactivate the motor protection.
	d) Main contacts in motor starter are not making contact or the coil is faulty.	Replace contacts or magnetic coil.
	e) Control circuit is defective.	Repair the control circuit.
	f) Motor is defective.	Replace the motor.
2. Motor starter overload trips out immediately when supply is switched on.	a) One fuse/automatic circuit breaker is blown.	Cut in the fuse.
	b) Contacts in motor starter overload are faulty.	Replace motor starter contacts.
	c) Cable connection is loose or faulty.	Fasten or replace the cable connection.
	d) Motor winding is defective.	Replace the motor.
	e) Pump mechanically blocked.	Remove the mechanical blocking of the pump.
	f) Overload setting is too low.	Set the motor starter correctly.
3. Motor starter overload trips out occasionally.	a) Overload setting is too low.	Set the motor starter correctly.
	b) Low voltage at peak times.	Check the power supply.
4. Motor starter has not tripped but the pump does not run.	a) Check 1 a), b), d) and e).	
5. Pump runs but gives no liquid or pump capacity is not constant.	a) Pump strainer partly blocked by impurities.	Clean the strainer.
	b) Liquid level in tank too low.	Increase the liquid level.
	c) Pump rotates in the wrong direction.	Change the direction of rotation of the motor.

## 9. Disposing of the product

This product or parts of it must be disposed of in an environmentally sound way:

1. Use the public or private waste collection service.
2. If this is not possible, contact the nearest Grundfos company or service workshop.



The crossed-out wheellie bin symbol on a product means that it must be disposed of separately from household waste. When a product marked with this symbol reaches its end of life, take it to a collection point designated by the local

waste disposal authorities. The separate collection and recycling of such products will help protect the environment and human health.

See also end-of-life information at [www.grundfos.com/product-recycling](http://www.grundfos.com/product-recycling).



## 中国 RoHS

产品中有害物质的名称及含量

部件名称	有害物质					
	铅 (Pb)	汞 (Hg)	镉 (Cd)	六价铬 (Cr6+)	多溴联苯 (PBB)	多溴联苯醚 (PBDE)
泵壳	X	0	0	0	0	0
紧固件	X	0	0	0	0	0
管件	X	0	0	0	0	0
定子	X	0	0	0	0	0
转子	X	0	0	0	0	0

本表格依据 SJ/T 11364 的规定编制

O: 表示该有害物质在该部件所有均质材料中的含量均在 GB/T 26572 规定的限量要求以下。

X: 表示该有害物质至少在该部件的某一均质材料中的含量超出 GB/T 26572 该规定的限量要求。



该产品环保使用期限为 10 年，标识如左图所示。

此环保期限只适用于产品在安装与使用说明书中所规定的条件下工作

## Declaration of conformity

---

### GB: EU declaration of conformity

We, Grundfos, declare under our sole responsibility that the product SPK, to which the declaration below relates, is in conformity with the Council Directives listed below on the approximation of the laws of the EU member states.

### KO: EU 적합성 선언

Grundfos 는 아래의 선언과 관련된 SPK 제품이 EU 회원국 법률에 기 반하여 아래의 이사회 지침을 준수함을 단독 책임 하에 선언합니다.

### CN: 欧盟符合性声明

我们，格兰富，在我们的全权责任下声明，产品 SPK 系列，其制造和性能完全符合以下所列欧盟委员会指令。

### TW: EU 合格聲明

葛蘭富根據我們唯一的責任，茲聲明與以下聲明相關之 SPK 產品，符合下列近似 EU 會員國法律之議會指令。

- Machinery Directive (2006/42/EC).  
Standard used: EN 809:1998, A1:2009.
- Ecodesign Directive (2009/125/EC).  
Electric motors:  
Commission Regulation No 640/2009.  
Applies only to three-phase Grundfos motors marked IE2 or IE3.  
See motor nameplate.  
Standard used: EN 60034-30:2009.
- Ecodesign Directive (2009/125/EC).  
Water pumps:  
Commission Regulation No 547/2012.  
Applies only to water pumps marked with the minimum efficiency index MEI. See pump nameplate.
- RoHS Directives: (2011/65/EU and 2015/863/EU)  
Standard used: EN IEC 63000:2018

This EC/EU declaration of conformity is only valid when published as part of the Grundfos installation and operating instructions (96496965).

Bjerringbro, 5th of January 2021



Erik Andersen  
Senior Manager  
GRUNDFOS Holding A/S  
Poul Due Jensens Vej 7  
8850 Bjerringbro, Denmark

Manufacturer and person empowered to sign the EC/EU declaration of conformity.

---

## UK declaration of conformity

We, Grundfos, declare under our sole responsibility that the product **SPK**, to which this declaration relates, is in conformity with UK regulations, standards and specifications to which conformity is declared, as listed below:

- Supply of Machinery (Safety) Regulations 2008  
Standard used: EN 809:1998, A1:2009.
- The Ecodesign for Energy-Related Products and Energy Information Regulations 2019  
Electric motors:  
Regulation (EC) No 640/2009 and Regulation (EU) No 4/2014  
Applies only to three-phase Grundfos motors marked IE2 or IE3.  
See motor nameplate.  
Standard used: EN 60034-30-1:2009.
- The Ecodesign for Energy-Related Products and Energy Information Regulations 2019  
Water pumps:  
Regulation (EU) No 547/2012.  
Applies only to water pumps marked with the minimum efficiency index MEI. See pump nameplate.
- The Restriction of the Use of Certain Hazardous Substances in Electrical and Electronic Equipment Regulations 2019  
Standard used: EN IEC 63000:2018

This UK declaration of conformity is only valid when published as part of the Grundfos installation and operating instructions.

UK Importer: Grundfos Pumps Ltd. Grovebury Road, Leighton Buzzard, LU7 4TL.

Bjerringbro, January 1, 2021



Erik Andersen  
Senior Manager  
Grundfos Holding A/S  
Poul Due Jensens Vej 7  
8850 Bjerringbro, Denmark

Manufacturer and person empowered to sign the UK declaration of conformity.

10000335766

**Argentina**

Bombas GRUNDFOS de Argentina S.A.  
Ruta Panamericana km. 37.500 Centro  
Industrial Garin  
1619 Garin Pcia. de B.A.  
Phone: +54-3327 414 444  
Telefax: +54-3327 45 3190

**Australia**

GRUNDFOS Pumps Pty. Ltd.  
P.O. Box 2040  
Regency Park  
South Australia 5942  
Phone: +61-8-8461-4611  
Telefax: +61-8-8340 0155

**Austria**

GRUNDFOS Pumpen Vertrieb  
Ges.m.b.H.  
Grundfosstraße 2  
A-5082 Grödig/Salzburg  
Tel.: +43-6246-883-0  
Telefax: +43-6246-883-30

**Belgium**

N.V. GRUNDFOS Bellux S.A.  
Boomsesteenweg 81-83  
B-2630 Aartselaar  
Tél.: +32-3-870 7300  
Télécopie: +32-3-870 7301

**Belarus**

Представительство ГРУНДФОС в  
Минске  
220125, Минск  
ул. Шафарнянская, 11, оф. 56, БЦ  
«Порт»  
Тел.: +375 17 397 397 3  
+375 17 397 397 4  
Факс: +375 17 397 397 1  
E-mail: minsk@grundfos.com

**Bosnia and Herzegovina**

GRUNDFOS Sarajevo  
Zmaja od Bosne 7-7A,  
BH-71000 Sarajevo  
Phone: +387 33 592 480  
Telefax: +387 33 590 465  
www.ba.grundfos.com  
e-mail: grundfos@bih.net.ba

**Brazil**

BOMBAS GRUNDFOS DO BRASIL  
Av. Humberto de Alencar Castelo  
Branco, 630  
CEP 09850 - 300  
São Bernardo do Campo - SP  
Phone: +55-11 4393 5533  
Telefax: +55-11 4343 5015

**Bulgaria**

Grundfos Bulgaria EOOD  
Slatina District  
Iztochna Tangenta street no. 100  
BG - 1592 Sofia  
Tel. +359 2 49 22 200  
Fax. +359 2 49 22 201  
email: bulgaria@grundfos.bg

**Canada**

GRUNDFOS Canada Inc.  
2941 Brighton Road  
Oakville, Ontario  
L6H 6C9  
Phone: +1-905 829 9533  
Telefax: +1-905 829 9512

**China**

GRUNDFOS Pumps (Shanghai) Co. Ltd.  
10F The Hub, No. 33 Suhong Road  
Minhang District  
Shanghai 201106  
PRC  
Phone: +86 21 612 252 22  
Telefax: +86 21 612 253 33

**COLOMBIA**

GRUNDFOS Colombia S.A.S.  
Km 1.5 vía Siberia-Cota Conj. Potrero  
Chico,  
Parque Empresarial Arcos de Cota Bod.  
1A.  
Cota, Cundinamarca  
Phone: +57(1)-2913444  
Telefax: +57(1)-8764586

**Croatia**

GRUNDFOS CROATIA d.o.o.  
Buzinski prilaz 38, Buzin  
HR-10010 Zagreb  
Phone: +385 1 6595 400  
Telefax: +385 1 6595 499  
www.hr.grundfos.com

**GRUNDFOS Sales Czechia and Slovakia s.r.o.**

Čajkovského 21  
779 00 Olomouc  
Phone: +420-585-716 111

**Denmark**

GRUNDFOS DK A/S  
Martin Bachs Vej 3  
DK-8850 Bjerringbro  
Tlf.: +45-87 50 50 50  
Telefax: +45-87 50 51 51  
E-mail: info\_GDK@grundfos.com  
www.grundfos.com/DK

**Estonia**

GRUNDFOS Pumps Eesti OÜ  
Peterburi tee 92G  
11415 Tallinn  
Tel: + 372 606 1690  
Fax: + 372 606 1691

**Finland**

OY GRUNDFOS Pumput AB  
Trukkikuja 1  
FI-01360 Vantaa  
Phone: +358-(0) 207 889 500

**France**

Pompes GRUNDFOS Distribution S.A.  
Parc d'Activités de Chesnes  
57, rue de Malacombe  
F-38290 St. Quentin Fallavier (Lyon)  
Tél.: +33-4 74 82 15 15  
Télécopie: +33-4 74 94 10 51

**Germany**

GRUNDFOS GMBH  
Schlüterstr. 33  
40699 Erkrath  
Tel.: +49-(0) 211 929 69-0  
Telefax: +49-(0) 211 929 69-3799  
e-mail: infoservice@grundfos.de  
Service in Deutschland:  
e-mail: kundendienst@grundfos.de

**Greece**

GRUNDFOS Hellas A.E.B.E.  
20th km. Athinon-Markopoulou Av.  
P.O. Box 71  
GR-19002 Peania  
Phone: +0030-210-66 83 400  
Telefax: +0030-210-66 46 273

**Hong Kong**

GRUNDFOS Pumps (Hong Kong) Ltd.  
Unit 1, Ground floor  
Siu Wai Industrial Centre  
29-33 Wing Hong Street &  
68 King Lam Street, Cheung Sha Wan  
Kowloon  
Phone: +852-27861706 / 27861741  
Telefax: +852-27858664

**Hungary**

GRUNDFOS Hungária Kft.  
Tópark u. 8  
H-2045 Törökbálint,  
Phone: +36-23 511 110  
Telefax: +36-23 511 111

**India**

GRUNDFOS Pumps India Private  
Limited  
118 Old Mahabalipuram Road  
Thoraipakkam  
Chennai 600 096  
Phone: +91-44 2496 6800

**Indonesia**

PT. GRUNDFOS POMPA  
Graha Intirub Lt. 2 & 3  
Jln. Cililitan Besar No.454. Makasar,  
Jakarta Timur  
ID-Jakarta 13650  
Phone: +62 21-469-51900  
Telefax: +62 21-460 6910 / 460 6901

**Ireland**

GRUNDFOS (Ireland) Ltd.  
Unit A, Merrywell Business Park  
Ballymount Road Lower  
Dublin 12  
Phone: +353-1-4089 800  
Telefax: +353-1-4089 830

**Italy**

GRUNDFOS Pompe Italia S.r.l.  
Via Gran Sasso 4  
I-20060 Truccazzano (Milano)  
Tel.: +39-02-95838112  
Telefax: +39-02-95309290 / 95838461

**Japan**

GRUNDFOS Pumps K.K.  
1-2-3, Shin-Miyakoda, Kita-ku,  
Hamamatsu  
431-2103 Japan  
Phone: +81 53 428 4760  
Telefax: +81 53 428 5005

**Korea**

GRUNDFOS Pumps Korea Ltd.  
6th Floor, Aju Building 679-5  
Yeoksam-dong, Kangnam-ku, 135-916  
Seoul, Korea  
Phone: +82-2-5317 600  
Telefax: +82-2-5633 725

**Latvia**

SIA GRUNDFOS Pumps Latvia  
Deglava biznesa centrs  
Augusta Deglava ielā 60, LV-1035, Rīga,  
Tālr.: + 371 714 9640, 7 149 641  
Fakss: + 371 914 9646

**Lithuania**

GRUNDFOS Pumps UAB  
Smolensko g. 6  
LT-03201 Vilnius  
Tel: + 370 52 395 430  
Fax: + 370 52 395 431

**Malaysia**

GRUNDFOS Pumps Sdn. Bhd.  
7 Jalan Peguam U1/25  
Glenmarie Industrial Park  
40150 Shah Alam  
Selangor  
Phone: +60-3-5569 2922  
Telefax: +60-3-5569 2866

**Mexico**

Bombas GRUNDFOS de México S.A. de  
C.V.  
Boulevard TLC No. 15  
Parque Industrial Stiva Aeropuerto  
Apodaca, N.L. 66600  
Phone: +52-81-8144 4000  
Telefax: +52-81-8144 2010

**Netherlands**

GRUNDFOS Netherlands  
Veluwezoom 35  
1326 AE Almere  
Postbus 22015  
1302 CA ALMERE  
Tel.: +31-88-478 6336  
Telefax: +31-88-478 6332  
E-mail: info\_gnl@grundfos.com

**New Zealand**

GRUNDFOS Pumps NZ Ltd.  
17 Beatrice Tinsley Crescent  
North Harbour Industrial Estate  
Albany, Auckland  
Phone: +64-9-415 3240  
Telefax: +64-9-415 3250

**Norway**

GRUNDFOS Pumper A/S  
Strømsveien 344  
Postboks 235, Leirdal  
N-1011 Oslo  
Tlf.: +47-22 90 47 00  
Telefax: +47-22 32 21 50

**Poland**

GRUNDFOS Pompy Sp. z o.o.  
ul. Klonowa 23  
Baranowo k. Poznań  
PL-62-081 Przeźmierowo  
Tel: (+48-61) 650 13 00  
Fax: (+48-61) 650 13 50

**Portugal**

Bombas GRUNDFOS Portugal, S.A.  
Rua Calvet de Magalhães, 241  
Apartado 1079  
P-2770-153 Paço de Arcos  
Tel.: +351-21-440 76 00  
Telefax: +351-21-440 76 90

**Romania**

Grundfos Pompe România SRL  
S-PARK BUSINESS CENTER, Clădirea  
A2,  
etaj 2, Str. Tipografilor, Nr. 11-15, Sector  
1,  
Cod 013714, Bucuresti, Romania,  
Tel: 004 021 2004 100  
E-mail: romania@grundfos.ro  
www.grundfos.ro

**Russia**

ООО Грундфос Россия  
ул. Школьная, 39-41  
Москва, RU-109544, Russia  
Тел. (+7) 495 564-88-00 (495) 737-30-  
00  
Факс (+7) 495 564 8811  
E-mail grundfos.moscow@grundfos.com

**Serbia**

Grundfos Srbija d.o.o.  
Omladinskih brigada 90b  
11070 Novi Beograd  
Phone: +381 11 2258 740  
Telefax: +381 11 2281 769  
www.rs.grundfos.com

**Singapore**

GRUNDFOS (Singapore) Pte. Ltd.  
25 Jalan Tukang  
Singapore 619264  
Phone: +65-6681 9688  
Telefax: +65-6681 9689

**Slovakia**

GRUNDFOS s.r.o.  
Prievozská 4D  
821 09 BRATISLAVA  
Phona: +421 2 5020 1426  
sk.grundfos.com

**Slovenia**

GRUNDFOS LJUBLJANA, d.o.o.  
Leskovoška 9e, 1122 Ljubljana  
Phone: +386 (0) 1 568 06 10  
Telefax: +386 (0) 1 568 06 19  
E-mail: tehnika-si@grundfos.com

**South Africa**

Grundfos (PTY) Ltd.  
16 Lascelles Drive, Meadowbrook Estate  
1609 Germiston, Johannesburg  
Tel.: (+27) 10 248 6000  
Fax: (+27) 10 248 6002  
E-mail: lgradidge@grundfos.com

**Spain**

Bombas GRUNDFOS España S.A.  
Camino de la Fuentesilla, s/n  
E-28110 Algete (Madrid)  
Tel.: +34-91-848 8800  
Telefax: +34-91-628 0465

**Sweden**

GRUNDFOS AB  
Box 333 (Lunnagårdsgatan 6)  
431 24 Mölndal  
Tel.: +46 31 332 23 000  
Telefax: +46 31 331 94 60

**Switzerland**

GRUNDFOS Pumpen AG  
Bruggacherstrasse 10  
CH-8117 Fällanden/ZH  
Tel.: +41-44-806 8111  
Telefax: +41-44-806 8115

**Taiwan**

GRUNDFOS Pumps (Taiwan) Ltd.  
7 Floor, 219 Min-Chuan Road  
Taichung, Taiwan, R.O.C.  
Phone: +886-4-2305 0868  
Telefax: +886-4-2305 0878

**Thailand**

GRUNDFOS (Thailand) Ltd.  
92 Chaloe Phrakiat Rama 9 Road,  
Dokmai, Pravej, Bangkok 10250  
Phone: +66-2-725 8999  
Telefax: +66-2-725 8998

**Turkey**

GRUNDFOS POMPA San. ve Tic. Ltd.  
Sti.  
Gebze Organize Sanayi Bölgesi  
İhsan dede Caddesi,  
2. yol 200. Sokak No. 204  
41490 Gebze/ Kocaeli  
Phone: +90 - 262-679 7979  
Telefax: +90 - 262-679 7905  
E-mail: satis@grundfos.com

**Ukraine**

Бізнес Центр Європа  
Столичне шосе, 103  
м. Київ, 03131, Україна  
Телефон: (+38 044) 237 04 00  
Факс.: (+38 044) 237 04 01  
E-mail: ukraine@grundfos.com

**United Arab Emirates**

GRUNDFOS Gulf Distribution  
P.O. Box 16768  
Jebel Ali Free Zone  
Dubai  
Phone: +971 4 8815 166  
Telefax: +971 4 8815 136

**United Kingdom**

GRUNDFOS Pumps Ltd.  
Grovebury Road  
Leighton Buzzard/Beds. LU7 4TL  
Phone: +44-1525-850000  
Telefax: +44-1525-850011

**U.S.A.**

GRUNDFOS Pumps Corporation  
9300 Loiret Blvd.  
Lenexa, Kansas 66219  
Phone: +1-913-227-3400  
Telefax: +1-913-227-3500

**Uzbekistan**

Grundfos Tashkent, Uzbekistan The  
Representative Office of Grundfos  
Kazakhstan in Uzbekistan  
38a, Oybek street, Tashkent  
Телефон: (+998) 71 150 3290 / 71 150  
3291  
Факс: (+998) 71 150 3292

Addresses Revised 09.09.2020

**99264365** 03.2021

ECM: 1308676

Trademarks displayed in this material, including but not limited to Grundfos, the Grundfos logo and "be think innovate" are registered trademarks owned by The Grundfos Group. All rights reserved. © 2021 Grundfos Holding A/S, all rights reserved.