

SP 17

Model B

Service instructions

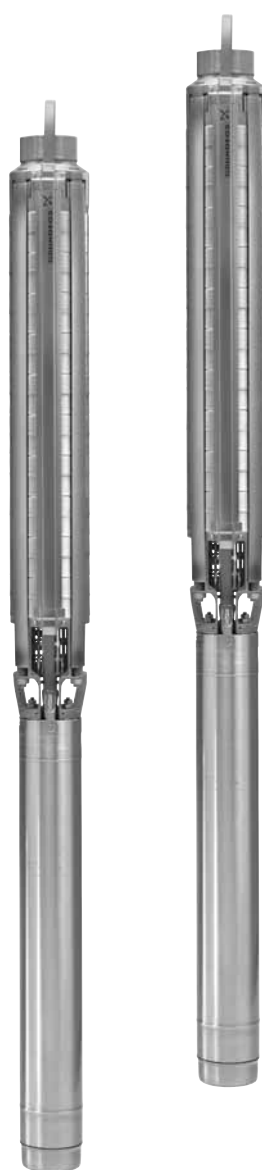

Original service instructions.

CONTENTS

	Page
1. Symbols used in this document	2
2. Identification	2
2.1 Nameplate	2
2.2 Type key	2
3. Tools	3
3.1 Special tools	3
3.2 Standard tools	4
3.3 Torque tools	4
3.4 Service video	4
4. Tightening torques and lubricants	5
5. Failure analysis	6
5.1 Before dismantling	6
6. Dismantling	6
6.1 Motor	6
6.2 Straps	6
6.3 Valve casing	7
6.4 Top chamber and impeller	7
6.5 Chambers	7
6.6 Bottom chamber with upthrust disc	8
7. Replacing the wear parts	8
7.1 Valve seat and rubber bearing, top chamber	8
7.2 Neck ring and rubber bearing, chambers	9
7.3 Wear ring, impeller	9
7.4 Valve casing	9
7.5 Suction interconnector	12
8. Pump assembly	12
8.1 Bottom impeller	12
8.2 Bottom chamber with upthrust disc	12
8.3 Chambers	13
8.4 Top chamber	13
8.5 Valve casing	13
8.6 Straps	13
9. Quality control	14
9.1 Rotating the shaft	14
9.2 Checking the pump axial clearance	14
9.3 Checking the motor shaft height	15
10. Checking the motor	15
10.1 Winding resistance	15
10.2 Insulation resistance	15
11. Mounting the motor and cable guard	15
11.1 Mounting the motor	15
11.2 Fitting the cable guard	15
12. Drawings	16
12.1 Exploded view	16
12.2 Sectional drawing	17
13. Analysis check list	18

1. Symbols used in this document

**Warning**

If these safety instructions are not observed, it may result in personal injury.

2. Identification

2.1 Nameplate

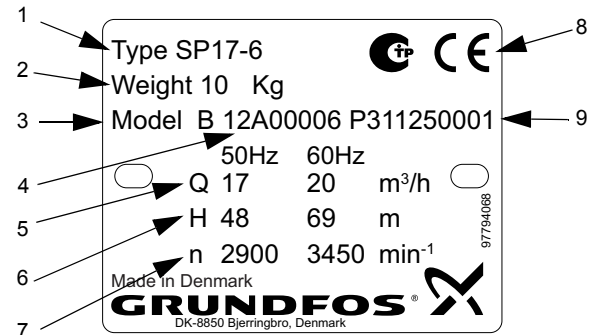

Fig. 1 Nameplate

Pos.	Description
1	Type designation
2	Weight [kg]
3	Model
4	Material number
5	Rated flow rate [m ³ /h]
6	Head at rated flow rate [m]
7	Speed [min ⁻¹]
8	CE mark and approvals
9	Production code

2.2 Type key

Example	SP 17 -6 N
Type range	
Rated flow rate [m ³ /h]	
Number of stages	
Material:	
= EN 1.4301	
N = EN 1.4401	
R = EN 1.4539	

Warning

Prior to service work, read these service instructions carefully. Installation and service work must comply with local regulations and accepted codes of good practice.

Observe the safety instructions in the installation and operating instructions for the product.



3. Tools

3.1 Special tools

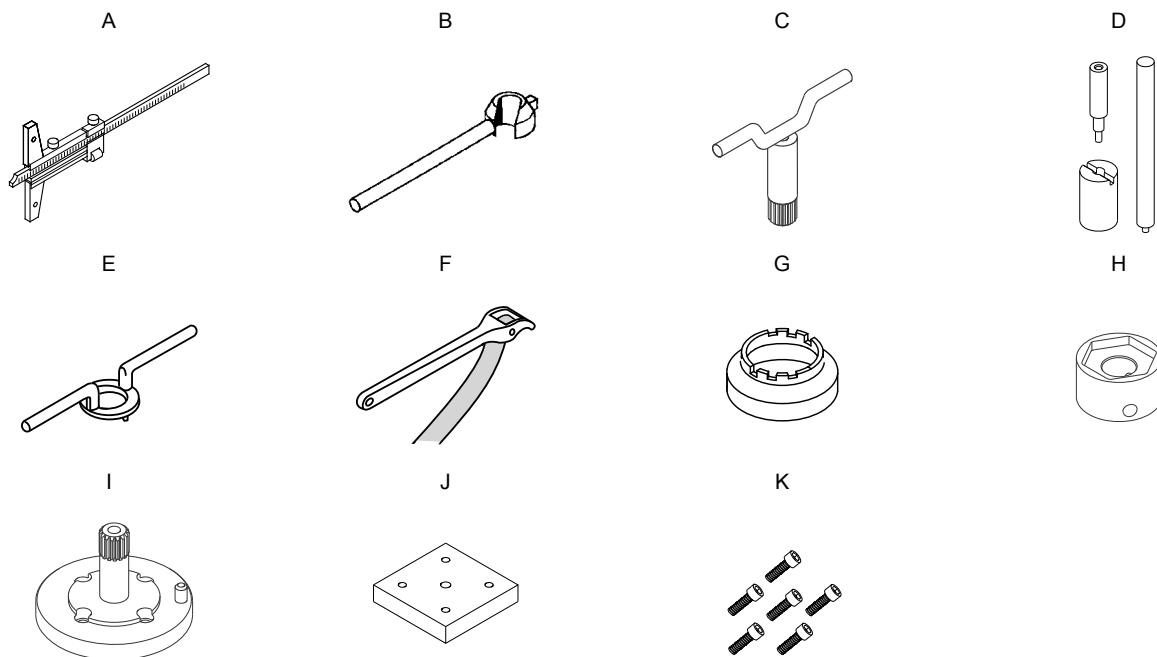

Pos.	Description	For pos.	Motor size	Further information	Part number
A	Depth gauge	14, 14a	4", 6", 8"	Measuring range up to 300 mm	00SV0834
B	Knock-out spanner	11	4", 6", 8"	Spanner size: 46 mm	00SV0121
C	Spline key	16	4"		00SV0351
			6"		00SV0352
			8"		00SV0353
D	Punch set for guide bearing	142a	4", 6", 8"	Set consisting of support tool, punch and shaft	98163675
E	Special key for fitting of sleeve		4", 6", 8"		00SV0290
F	Band pipe wrench for fitting of sleeve		4", 6", 8"		00SV0853
G	Holder for wear ring	72	4", 6", 8"		00SV0893
H	Spanner for retainer ring tool	S, 203	4", 6", 8"		00SV0874
			4"		97620192
			6"		97620193
I	Adaptor	14, 14a	8"		97620194
			4", 6", 8"		98164171
J	Mounting plate	I	4", 6", 8"		98164171
K	Set of hexagon socket head screws for mounting plate and adaptor	I, J	4", 6", 8"	4 x M8 x 20, 1 x M8 x 75, 1 x M10 x 115, 1 x M10 x 145	98287940

3.2 Standard tools

L



M

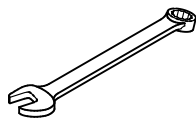

N

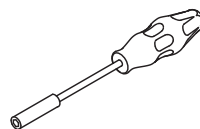

O

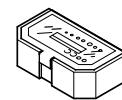

Pos.	Description	For pos.	Motor size	Further information	Part number
L	Hexagon key set	K	4", 6", 8"		97656148
M	Ring spanner			Spanner size: 13 mm	00SV0055
				Spanner size: 17 mm	00SV0056
				Spanner size: 19 mm	00SV0054
N	Screwdriver for bits	18d	4", 6", 8"		00SV2011
O	Bits kit		4", 6", 8"		00SV2010

3.3 Torque tools

P

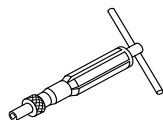

Q

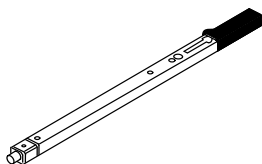

R



S



T

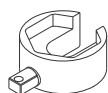

Pos.	Description	For pos.	Motor size	Further information	Part number
P	Torque screwdriver	18d	4", 6", 8"	1-6 Nm	00SV0438
Q	Torque wrench	11, 19	4", 6", 8"	20-100 Nm	00SV0269
		203	4", 6", 8"	20-200 Nm	00SV0400
		19	4", 6", 8"	Spanner size: 17 mm	00SV0270
R	Ring spanner for torque wrench	19	4", 6", 8"	Spanner size: 19 mm	00SV0519
S	Retainer ring tool for torque wrench	203	4", 6", 8"		97937290
T	Split cone spanner for torque wrench	11	4", 6", 8"		96937573

3.4 Service video

As an additional tool and supplement to these service instructions, we offer a service video which shows the following procedures:

- dismantling
- replacement of wear parts
- pump assembly
- quality control.

The service video is available on www.grundfos.com/WebCAPS.

4. Tightening torques and lubricants

Pos.	Description	Motor size	Quantity	Dimension	Supplementary information	Torque ¹⁾ [Nm]	Lubricant
58	Staybolt for motor	8"	4	M16			
58a	Nut for staybolt	8"	4	M16		150	
22	Bolt	6", 8"	4	M12		70	
22a	Nut for staybolt	4"	4	M8		18	
					First stage	15	
			4	M10	Second stage	25	
					Third stage	35	
19	Nut for strap ²⁾	4", 6", 8"			First stage	25	O-ring grease
			4	M12	Second stage	35	
					Third stage (pump with sleeve)	45	
11	Split cone nut	4", 6", 8"				45	
203	Retainer for valve seat	4", 6", 8"	1			150	
18d	Screw for clamp	4", 6", 8"	4	M4		2.5	
7	Neck ring	4", 6", 8"					Soapy water with a concentration of 3 to 5 %

¹⁾ The torque tolerance in all tightening steps is 10 % of the stated torque.

²⁾ Tighten the nut in three steps to ensure that the pump is tightened correctly.

5. Failure analysis

If the pump has to be dismantled for replacement of any part, it is important to identify the cause of the fault, especially if the pump has been damaged. Always take care to thoroughly inspect, analyse and document each individual component, both before and during dismantling.

Use the check list in section 13. *Analysis check list* as a guide for inspection of the components.

5.1 Before dismantling

1. Disconnect the power supply to the motor.
2. Remove the submersible drop cable from the power supply.
3. Close the isolating valves, if installed, to avoid draining the system.



Warning

When lifting the pump, note the centre of gravity of the pump to prevent it from overturning. This is especially important in the case of long pumps.

- Clean the workplace.
- Sort and clean tools.

6. Dismantling

Be systematic when dismantling the pump.

Follow the instructions below.

Position numbers of pump components (digits) refer to section 12. *Drawings*.

Position numbers of tools (letters) refer to section 3. *Tools*.

6.1 Motor



TM05 5476 3712

1. Remove screws (pos. 18d) and then remove top and bottom cable guard clamps (pos. 18b/18c).
2. Remove cable guard (pos. 18).
Do not remove the motor cable from the motor, unless required. The sealing might be damaged.

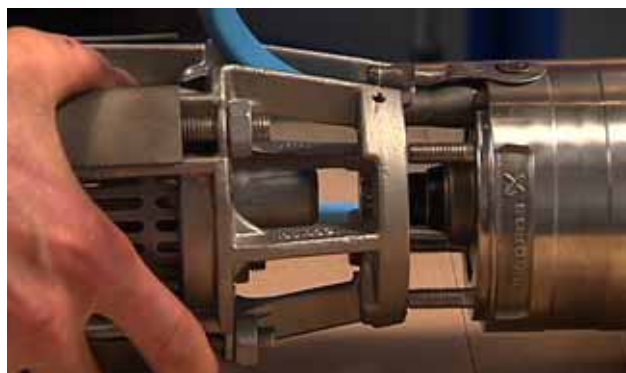

TM05 4173 2012

3. Cross-loosen the nuts (pos. 22a) holding the motor.
4. Pull the motor off the pump.

6.2 Straps



TM05 4504 2412

1. Fasten the adaptor (pos. I) to the mounting plate (pos. J) with the hexagon socket head screws (pos. K).



TM05 4174 2012

2. Fasten the adaptor to the chamber stack.
Check that the recess of the adaptor fits into the recess of the suction interconnector (pos. 14/14a).



TM05 4175 2012

3. Fix the mounting plate with chamber stack in a vice.



TM05 4176 2012

4. Cross-loosen and remove the nuts (pos. 19) from the straps (pos. 17).



TM05 4177 2012

5. Remove the straps.

6.3 Valve casing



TM05 4178 2012

1. Remove valve casing (pos. 1/1a), valve cup (pos. 2) and top chamber (pos. 4/4a).
In large pump models, the valve casing, valve seat and valve cup are combined in a relieved valve casing (pos. 1a).

6.4 Top chamber and impeller



TM05 4179 2012

1. Loosen the split cone nut (pos. 11) with the knock-out spanner (pos. B).



TM05 4180 2012

2. Turn the knock-out spanner upside down and knock on the nut with a plastic mallet. The split cone (pos. 12) will then loosen its grip on the shaft.
3. Remove impeller (pos. 13).

6.5 Chambers



TM05 5477 3712

1. Continue the dismantling as described in the previous section until the upthrust disc (pos. 8a) is reached.

6.6 Bottom chamber with upthrust disc



TM05 5478 3712

1. Remove the upthrust disc (pos. 8a) from the shaft.
2. Loosen the split cone nut (pos. 11) with the knock-out spanner (pos. B).
3. Turn the knock-out spanner upside down and knock on the split cone nut with a plastic mallet. The split cone (pos. 12) will then loosen its grip on the shaft.
4. Remove the bottom impeller (pos. 13).

7. Replacing the wear parts

When replacing wear parts of the pump, clean and check all parts.

Always replace all parts from a service kit and replace all neck rings and O-rings.

7.1 Valve seat and rubber bearing, top chamber



TM05 5479 3712

1. Press a screwdriver under the valve seat/neck ring (pos. 3/7) and push it out of the recess.



TM05 5480 3712

2. Press out the rubber bearing (pos. 8) on the back of the chamber with a screwdriver.



TM05 5482 3712

3. Clean the recess where the rubber bearing was fitted.
4. Moisten the recess with soapy water, and press the new rubber bearing home in the recess.



TM05 5501 3712

5. Make sure that the bearing is fitted properly in the chamber.



TM05 5481 3712

6. Clean the recess where the valve seat/neck ring was fitted.
7. Moisten the valve seat/neck ring with soapy water, and knock the new neck ring home in the recess with a plastic mallet. See section 3. *Tools*.
8. When the neck ring has been replaced, the text "This side up" on the neck ring must point upwards.

7.2 Neck ring and rubber bearing, chambers



TM05 4189 2012

1. Replace all neck rings and rubber bearings in the chambers as described above.

7.3 Wear ring, impeller



TM05 4190 2012

1. Remove the wear ring (pos. 72) with the holder (pos. G) and a screwdriver.



TM05 4191 2012

2. Clean and lubricate the impeller skirt.
3. Carefully press the new wear ring straight down over the impeller skirt with a hydraulic or manual punch press.
4. Check that the wear ring is pressed home and that the impeller is not deformed.

7.4 Valve casing

7.4.1 Standard valve casing



TM05 4194 2012

1. Position the valve casing (pos. 1) upside down on the support tool from the punch set (pos. D).



TM05 4195 2012

2. Centre the guide bearing (pos. 142a) with the hole in the support tool.



TM05 4196 2012

3. Position the punch in the centre of the guide bearing and knock it out with a plastic mallet.



TM05 4197 2012

4. Turn the support tool upside down so that its recess is pointing upwards.
5. Position the valve casing on top of the tool with the outlet pointing upwards.



TM05 4198 2012

6. Fit the new guide bearing on the punch.



TM05 4202 2012

3. Place the spanner (pos. H) over the retainer ring tool and loosen the retainer ring.
4. Remove the retainer ring and valve cup (pos. 2).



TM05 4199 2012

7. Position the new guide bearing in the valve casing.
8. Knock the guide bearing home with a plastic mallet.



TM05 4203 2012

5. Position the valve casing upside down on the support tool from the punch set (pos. D).



TM05 4200 2012

9. Insert the valve cup (pos. 2) into the valve casing.



TM05 4204 2012

6. Centre the guide bearing (pos. 142a) with the hole in the support tool.

7.4.2 Relieved valve casing



TM05 4201 2012

1. Fix the relieved valve casing (pos. 1a) upside down in a vice.
2. Fit the retainer ring tool (pos. S) in the retainer ring (pos. 203) for valve seat.



TM05 4205 2012

7. Position the punch tool in the centre of the guide bearing and knock it out with a plastic mallet.



TM05 4206 2012

8. Turn the support tool upside down so that its recess is pointing upwards.
9. Position the valve casing on top of the support tool with the outlet pointing upwards.



TM05 4207 2012

10. Position the new guide bearing in the valve casing.
11. Knock the guide bearing home with a plastic mallet.



TM05 4208 2012

12. Remove the O-ring (pos. 37) from the retainer ring with a screwdriver.



TM05 4209 2012

13. Fix the retainer ring in a vice.
14. Knock out the valve seat (pos. 3) with a punch.



TM05 4210 2012

15. Clean the recess where the O-ring was fitted.
16. Moisten the recess with soapy water, and fit a new O-ring.



TM05 4211 2012

17. Clean the recess where the valve seat was fitted.
18. Moisten the recess with soapy water, and knock home a new valve seat.



TM05 4212 2012

19. Fix the valve casing in a vice.
20. Fit the valve cup and retainer ring in the valve casing.



TM05 4213 2012

21. Tighten the retainer ring with the specified torque. See section 4. *Tightening torques and lubricants.*

7.5 Suction interconnector



TM05 5502 3712

1. Push the neck ring (pos. 7) out of its retainer with a screwdriver.

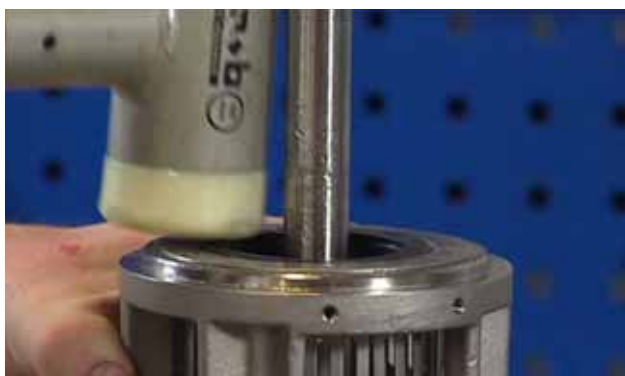

TM05 5503 3712

2. Clean the retainer where the neck ring was fitted.
3. Moisten the retainer with soapy water, and fit a new neck ring.
4. When the neck ring has been replaced, the text "This side up" on the neck ring must point upwards.

8. Pump assembly

8.1 Bottom impeller



TM05 5504 3712

1. Fit the bottom impeller (pos. 13).



TM05 5505 3712

2. Tighten the split cone nut (pos. 11) with the specified torque, using a torque wrench (pos. Q) together with the split cone spanner (pos. T). See section 4. *Tightening torques and lubricants.*

8.2 Bottom chamber with upthrust disc



TM05 5478 3712

1. Fit the upthrust disc (pos. 8a) on top of the bottom impeller.



TM05 5506 3712

2. Fit a chamber (pos. 9) to the suction interconnector (pos. 14/14a).

8.3 Chambers



TM05 5488 3712

1. Fit an impeller (pos. 13) to the bottom chamber (pos. 9).
2. Tighten the split cone nut (pos. 11) with the specified torque, using a torque wrench (pos. Q) together with the split cone spanner (pos. T). See section 4. *Tightening torques and lubricants*.
3. Repeat this procedure until all impellers and intermediate chambers have been fitted.

8.4 Top chamber



TM05 5489 3712

1. Fit the top impeller (pos. 13) and tighten the split cone nut (pos. 11) with the specified torque. See section 4. *Tightening torques and lubricants*.
2. Fit the top chamber (pos. 4/4a).

8.5 Valve casing



TM05 5490 3712

1. Fit the valve casing/relieved valve casing (pos. 1/1a) on the top chamber (pos. 4/4a).
2. Position the valve casing so that the threaded holes for the cable guards (pos. 18) are in line with the threaded holes in the suction interconnector (pos. 14/14a).

8.6 Straps



TM05 5491 3712

1. Fit the straps (pos. 17) in the suction interconnector (pos. 14/14a).
2. Lubricate the thread of the straps with O-ring grease.



TM05 5492 3712

3. Fit the strap to the valve casing (pos. 1/1a).



TM05 5493 3712

4. Fit nuts (pos. 19) and cross-tighten them in three steps with the specified torque. See section 4. *Tightening torques and lubricants*.

9. Quality control

9.1 Rotating the shaft



TM05 5494 3712

1. Position the pump so that it is easy to turn the shaft.
2. Insert the spline key (pos. C) into the shaft spline.
3. Give the spline key two turns clockwise and counter-clockwise. It should be possible to turn the shaft in both directions with little force only.

9.2 Checking the pump axial clearance

9.2.1 Axial clearance, shaft in top position



TM05 5495 3712

1. Press the shaft home in top position with the spline key (pos. C).



TM05 5496 3712

2. Measure the top axial clearance from the bottom of the coupling to the end of the suction interconnector (pos. 14/14a).
3. Note down the measured axial clearance.

9.2.2 Axial clearance, shaft in bottom position



TM05 5497 3712

1. Turn the shaft with the spline key (pos. C) while pulling the shaft into bottom position.



TM05 5498 3712

2. Measure the bottom axial clearance from the bottom of the coupling to the end of the suction interconnector (pos. 14/14a).
3. Note down the measured axial clearance.

9.2.3 Check list

If there is no clearance (end play) or the measured clearance differs from the values stated below, the assembly has not been made correctly. The pump must therefore be dismantled and reassembled.

Motor size	Axial clearance [mm]	
	Shaft in bottom position	Shaft in top position
4"	35.5 - 36.5	39.0 - 41.5
6"	70.5 - 71.5	74.0 - 76.5
8"	99.5 - 100.5	103.0 - 105.5

9.3 Checking the motor shaft height



TM05 4233 2012

1. Measure the shaft height from the top of the shaft to the motor frame.
2. Note down the measured shaft height.

9.3.1 Check list

If the measured shaft height differs from the value stated below, adjust the axial bearing in the motor.

Motor size	Motor type	Tolerated shaft height [mm]
4"	Grundfos	38.15 + 0.15 / - 0.15
	Franklin	38.18 + 0.12 / - 0.12
6"	Grundfos	73.00 + 0.00 / - 0.40
	Mercury	73.00 + 0.03 / - 0.35
	Franklin	73.00 + 0.02 / - 0.12
8"	-	101.00 + 0.60 / - 0.34

10. Checking the motor

10.1 Winding resistance

1. Disconnect the power supply to the motor.
2. Remove the submersible drop cable from the power supply.
3. Measure the winding resistance between the leads of the drop cable.

For three-phase motors, the deviation between the highest and the lowest value should not exceed 10 %. If the deviation is higher, pull out the motor. Measure motor, motor cable and drop cable separately, and repair or replace defective parts.

Note: On single-phase, 3-wire motors, the operating winding will assume the lowest resistance value.

10.2 Insulation resistance

1. Disconnect the power supply to the motor.
2. Remove the submersible drop cable from the power supply.
3. Measure the insulation resistance from each phase to earth (frame). Make sure that the earth connection is made carefully.

If the insulation resistance is lower than 0.5 MΩ, the motor should be pulled out for motor or cable repair. Local regulations may specify other values for the insulation resistance.

For further instructions, see the service instructions for MS/MMS.

11. Mounting the motor and cable guard

11.1 Mounting the motor



TM05 4234 2012

1. Mount the motor on the chamber stack.
2. Lubricate the motor staybolts with O-ring grease.
3. Fit the nuts (pos. 22a) on the staybolts.
4. Cross-tighten the nuts in three steps with the specified torque. See section 4. *Tightening torques and lubricants.*

11.2 Fitting the cable guard



TM05 5499 3712

1. Place the cable along the chamber stack, and position the cable guard (pos. 18) over the cable.



TM05 5500 3712

2. Fit the clamps (pos. 18b/18c) at the top and bottom of the chamber stack.
3. Fit the screws (pos. 18d) in the top and bottom clamps. Tighten the screws with the specified torque, using a torque screwdriver (pos. P). See section 4. *Tightening torques and lubricants.*

12. Drawings

12.1 Exploded view

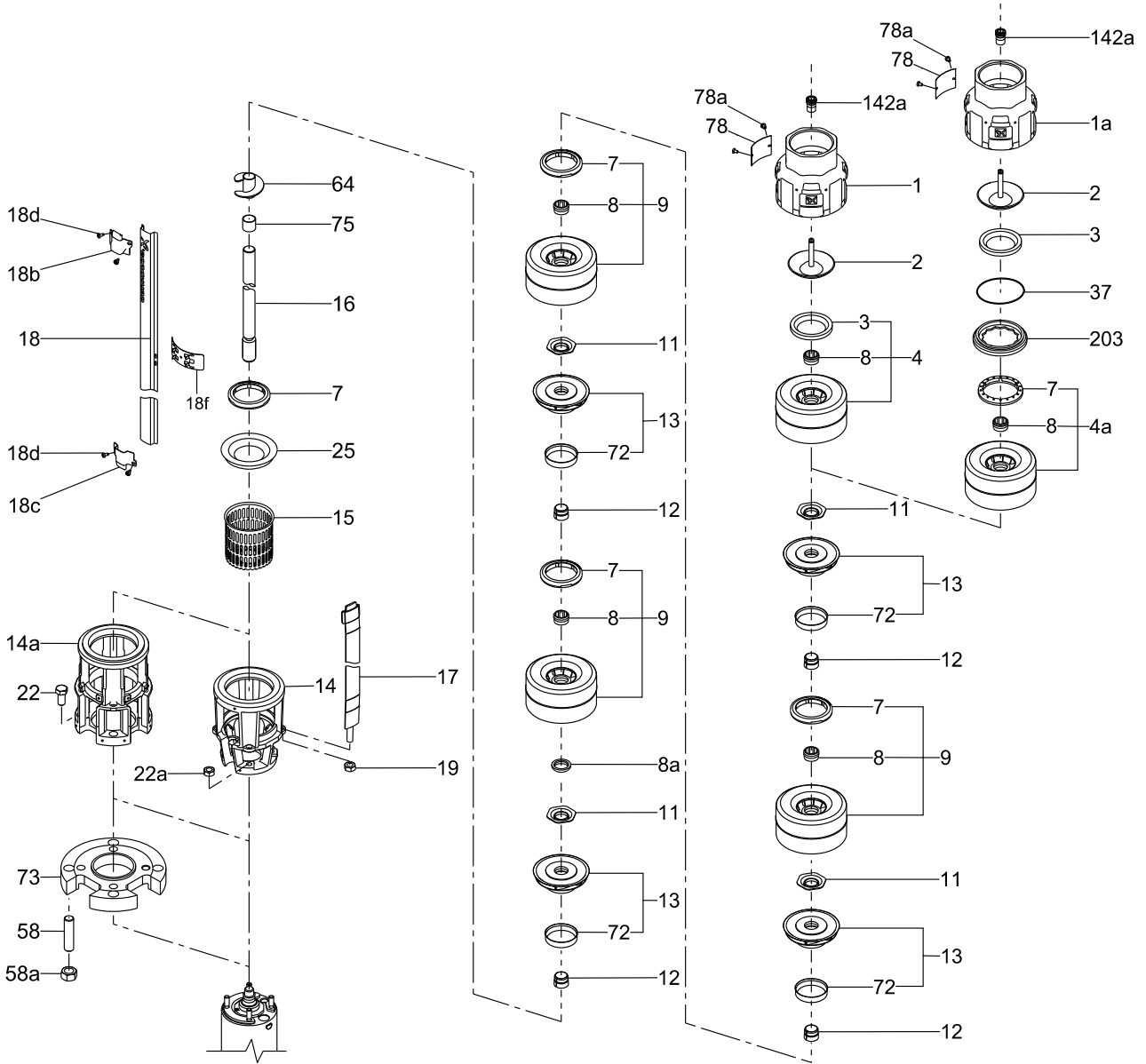

Fig. 2 SP 17

12.2 Sectional drawing

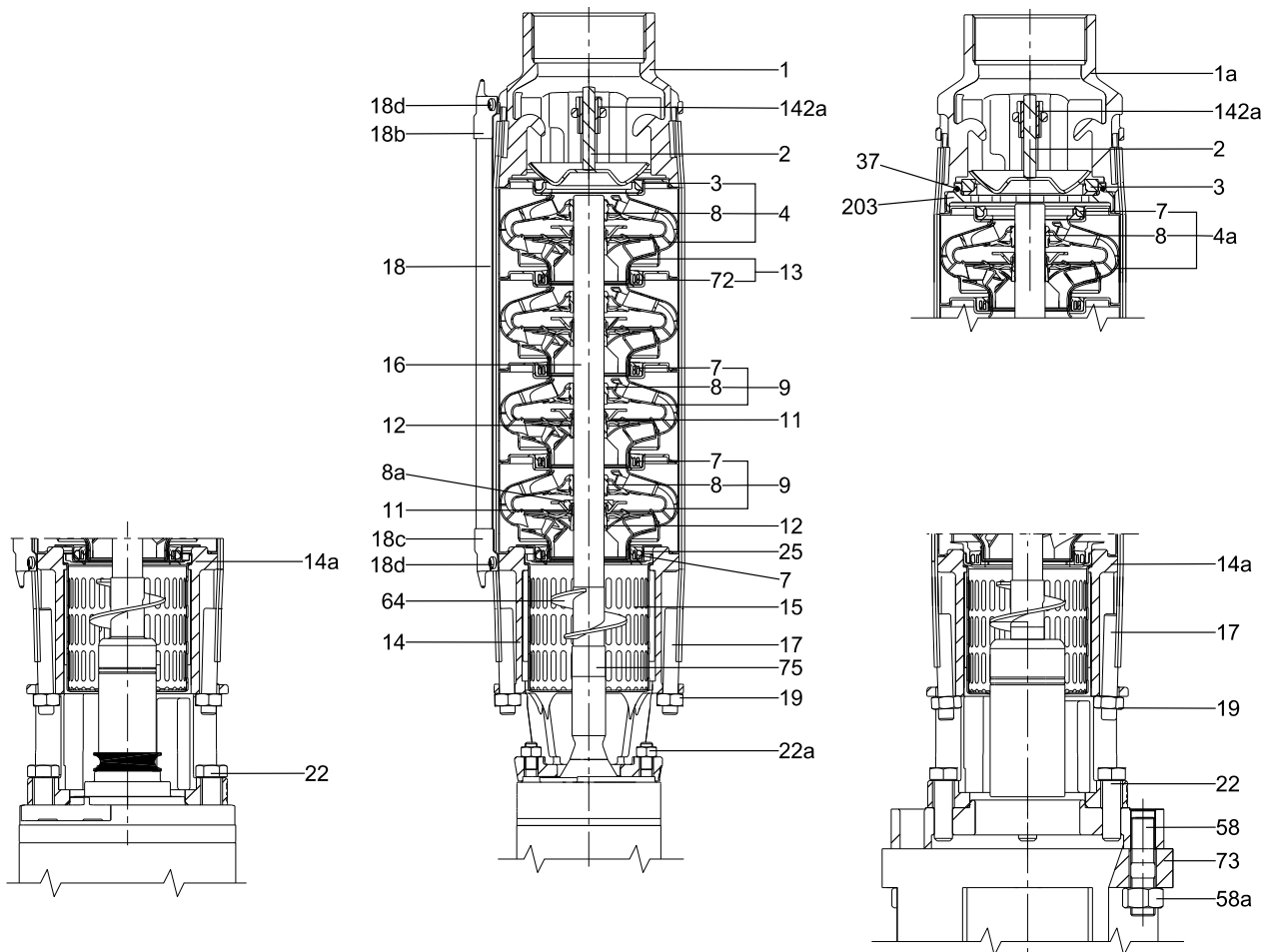

Fig. 3 SP 17

Pos.	Description
1	Standard valve casing
1a	Relieved valve casing
2	Valve cup
3	Valve seat
4	Top chamber, complete (for standard valve casing)
4a	Top chamber, complete (for relieved valve casing)
7	Neck ring
8	Rubber bearing
8a	Upthrust disc
9	Chamber, complete
11	Split cone nut
12	Split cone
13	Impeller, complete
14	Suction interconnector, 4"
14a	Suction interconnector, 6"
15	Strainer
16	Shaft
17	Strap
18	Cable guard

Pos.	Description
18b	Clamp, top
18c	Clamp, bottom
18d	Screw
18	Bracket for cable guard
19	Nut
22	Bolt
22a	Nut
25	Retainer for neck ring
37	O-ring
58	Staybolt
58a	Nut
64	Priming screw
72	Wear ring
73	Connecting piece, 8"
75	Bush
78	Nameplate
78a	Rivet
142a	Guide bearing
203	Retainer ring

TM05 5458 3812

13. Analysis check list

Component	Problem	Yes/No	Comment
Inspect before dismantling			
Motor	Any dents, in motor?		
	Damaged motor cable?		
	Cable plug intact?		
	Damaged motor/submersible drop cable joint?		
	Damaged submersible drop cable?		
	Signs of corrosion, where?		
Pump	Broken or damaged strainer?		
	Non-return valve functional?		
	Any loose straps?		
	Any dents, in pump?		
	Signs of corrosion, where?		
Inspect during dismantling			
Motor	Motor coupling undamaged?		
	Measure shaft height [mm]		
	Can the pump turn freely? (light resistance is expected)		
Pump	Pump coupling undamaged?		
	Measure axial clearance, top position [mm]		
	Measure axial clearance, bottom position [mm]		
	Can it turn freely? (light resistance is expected)		
Valve casing	Wear on valve cup and guide pin?		
Valve casing, relieved	Wear on valve seat and O-ring?		
Top chamber and impeller	Wear on rubber bearing?		
	Are the chamber guide vanes intact?		
	Wear on valve seat or neck ring?		
	Wear on split cone and nut?		
	Wear on impeller wear ring?		
	Are the impeller blades intact?		
	Signs of corrosion, where?		
Intermediate chambers	Wear on rubber bearing?		
	Are the chamber guide vanes intact?		
	Wear on neck ring?		
	Wear on split cone and nut?		
	Wear on impeller wear ring?		
	Are the impeller blades intact?		
	Signs of corrosion, where?		
Bottom chamber	Are the chamber guide vanes intact?		
	Any unexpected wear on neck ring?		
	Are the chamber guide vanes intact?		
	Abnormal wear on stop ring?		
	Are the bearing cups free of dents and wear?		
	Is the upthrust disc intact?		
	Wear on split cone?		
	Wear on nut for stop ring?		
	Wear on impeller wear ring?		
	Are the impeller blades intact?		
Signs of corrosion, where?			
Suction interconnector	Wear on neck ring?		
	Signs of corrosion, where?		
Shaft	Free of wear, burrs and scratches?		
	Is the shaft straight?		
	Signs of corrosion, where?		

Subject to alterations.

Argentina

Bombas GRUNDFOS de Argentina S.A.
Ruta Panamericana, ramal Campana Centro Industrial Garin - Esq. Haendel y Mozart
AR-1619 Garin Pcia. de Buenos Aires
Pcia. de Buenos Aires
Phone: +54-3327 414 444
Telefax: +54-3327 45 3190

Australia

GRUNDFOS Pumps Pty. Ltd.
P.O. Box 2040
Regency Park
South Australia 5942
Phone: +61-8-8461-4611
Telefax: +61-8-8340 0155

Austria

GRUNDFOS Pumpen Vertrieb Ges.m.b.H.
Grundfosstraße 2
A-5082 Grödig/Salzburg
Tel.: +43-6246-883-0
Telefax: +43-6246-883-30

Belgium

N.V. GRUNDFOS Bellux S.A.
Boomssesteenweg 81-83
B-2630 Aartselaar
Tél.: +32-3-870 7300
Télécopie: +32-3-870 7301

Belarus

Представительство ГРУНДФОС в Минске
220123, Минск,
ул. В. Хоружей, 22, оф. 1105
Тел.: +(37517) 233 97 65,
Факс: +(37517) 233 97 69
E-mail: grundfos_minsk@mail.ru

Bosnia/Herzegovina

GRUNDFOS Sarajevo
Trg Heroja 16,
BiH-71000 Sarajevo
Phone: +387 33 713 290
Telefax: +387 33 659 079
e-mail: grundfos@bih.net.ba

Brazil

BOMBAS GRUNDFOS DO BRASIL
Av. Humberto de Alencar Castelo Branco, 630
CEP 09850 - 300
São Bernardo do Campo - SP
Phone: +55-11 4393 5533
Telefax: +55-11 4343 5015

Bulgaria

Grundfos Bulgaria EOOD
Slatina District
Iztochna Tangenta street no. 100
BG - 1592 Sofia
Tel. +359 2 49 22 200
Fax. +359 2 49 22 201
email: bulgaria@grundfos.bg

Canada

GRUNDFOS Canada Inc.
2941 Brighton Road
Oakville, Ontario
L6H 6C9
Phone: +1-905 829 9533
Telefax: +1-905 829 9512

China

GRUNDFOS Pumps (Shanghai) Co. Ltd.
50/F Maxdo Center No. 8 XingYi Rd.
Hongqiao development Zone
Shanghai 200336
PRC
Phone: +86 21 612 252 22
Telefax: +86 21 612 253 33

Croatia

GRUNDFOS CROATIA d.o.o.
Cebini 37, Buzin
HR-10010 Zagreb
Phone: +385 1 6595 400
Telefax: +385 1 6595 499
www.grundfos.hr

Czech Republic

GRUNDFOS s.r.o.
Čajkovského 21
779 00 Olomouc
Phone: +420-585-716 111
Telefax: +420-585-716 299

Denmark

GRUNDFOS DK A/S
Martin Bachs Vej 3
DK-8850 Bjerringbro
Tlf.: +45-87 50 50 50
Telefax: +45-87 50 51 51
E-mail: info_GDK@grundfos.com
www.grundfos.com/DK

Estonia

GRUNDFOS Pumps Eesti OÜ
Peterburi tee 92G
11415 Tallinn
Tel: + 372 606 1690
Fax: + 372 606 1691

Finland

OY GRUNDFOS Pumput AB
Mestarintie 11
FIN-01730 Vantaa
Phone: +358-3066 5650
Telefax: +358-3066 56550

France

Pompes GRUNDFOS Distribution S.A.
Parc d'Activités de Chesnes
57, rue de Malacombe
F-38290 St. Quentin Fallavier (Lyon)
Tél.: +33-4 74 82 15 15
Télécopie: +33-4 74 94 10 51

Germany

GRUNDFOS GMBH
Schlüterstr. 33
40699 Erkrath
Tel.: +49-(0) 211 929 69-0
Telefax: +49-(0) 211 929 69-3799
e-mail: infoservice@grundfos.de
Service in Deutschland:
e-mail: kundendienst@grundfos.de

HILGE GmbH & Co. KG

Hilgestrasse 37-47
55292 Bodenheim/Rhein
Germany
Tel.: +49 6135 75-0
Telefax: +49 6135 1737
e-mail: hilge@hilge.de

Greece

GRUNDFOS Hellas A.E.B.E.
20th km. Athinon-Markopoulou Av.
P.O. Box 71
GR-19002 Peania
Phone: +0030-210-66 83 400
Telefax: +0030-210-66 46 273

Hong Kong

GRUNDFOS Pumps (Hong Kong) Ltd.
Unit 1, Ground floor
Siu Wai Industrial Centre
29-33 Wing Hong Street &
68 King Lam Street, Cheung Sha Wan
Kowloon
Phone: +852-27861706 / 27861741
Telefax: +852-27858664

Hungary

GRUNDFOS Hungária Kft.
Park u. 8
H-2045 Törökbálint,
Phone: +36-23 511 110
Telefax: +36-23 511 111

India

GRUNDFOS Pumps India Private Limited
118 Old Mahabaliapuram Road
Thoraiakkam
Chennai 600 096
Phone: +91-44 2496 6800

Indonesia

PT GRUNDFOS Pompa
Jl. Rawa Sumur III, Blok III / CC-1
Kawasan Industri, Pulogadung
Jakarta 13930
Phone: +62-21-460 6909
Telefax: +62-21-460 6910 / 460 6901

Ireland

GRUNDFOS (Ireland) Ltd.
Unit A, Merrywell Business Park
Ballymount Road Lower
Dublin 12
Phone: +353-1-4089 800
Telefax: +353-1-4089 830

Italy

GRUNDFOS Pompe Italia S.r.l.
Via Gran Sasso 4
I-20060 Truccazzano (Milano)
Tel.: +39-02-95838112
Telefax: +39-02-95309290 / 95838461

Japan

GRUNDFOS Pumps K.K.
Gotanda Metalion Bldg., 5F,
5-21-15, Higashi-gotanda
Shiagawa-ku, Tokyo
141-0022 Japan
Phone: +81 35 448 1391
Telefax: +81 35 448 9619

Korea

GRUNDFOS Pumps Korea Ltd.
6th Floor, Aju Building 679-5
Yeoksam-dong, Kangnam-ku, 135-916
Seoul, Korea
Phone: +82-2-5317 600
Telefax: +82-2-5633 725

Latvia

SIA GRUNDFOS Pumps Latvia
Deglava biznesa centrs
Augusta Deglava ielā 60, LV-1035, Rīga,
Tālr.: + 371 714 9640, 7 149 641
Fakss: + 371 914 9646

Lithuania

GRUNDFOS Pumps UAB
Smolensko g. 6
LT-03201 Vilnius
Tel: + 370 52 395 430
Fax: + 370 52 395 431

Malaysia

GRUNDFOS Pumps Sdn. Bhd.
7 Jalan Peguam U1/25
Glenmarie Industrial Park
40150 Shah Alam
Selangor
Phone: +60-3-5569 2922
Telefax: +60-3-5569 2866

Mexico

Bombas GRUNDFOS de México S.A. de C.V.
Boulevard TLC No. 15
Parque Industrial Stiva Aeropuerto
Apodaca, N.L. 66600
Phone: +52-81-8144 4000
Telefax: +52-81-8144 4010

Netherlands

GRUNDFOS Netherlands
Veluwezoom 35
1326 AE Almere
Postbus 22015
1302 CA ALMERE
Tel.: +31-88-478 6336
Telefax: +31-88-478 6332
E-mail: info_gnl@grundfos.com

New Zealand

GRUNDFOS Pumps NZ Ltd.
17 Beatrice Tinsley Crescent
North Harbour Industrial Estate
Albany, Auckland
Phone: +64-9-415 3240
Telefax: +64-9-415 3250

Norway

GRUNDFOS Pumper A/S
Stramsveien 344
Postboks 235, Leirdal
N-1011 Oslo
Tlf.: +47-22 90 47 00
Telefax: +47-22 32 21 50

Poland

GRUNDFOS Pompy Sp. z o.o.
ul. Klonowa 23
Baranowo k. Poznania
PL-62-081 Przeźmierowo
Tel: (+48-61) 650 13 00
Fax: (+48-61) 650 13 50

Portugal

Bombas GRUNDFOS Portugal, S.A.
Rua Calvet de Magalhães, 241
Apartado 1079
P-2770-153 Paço de Arcos
Tel.: +351-21-440 76 00
Telefax: +351-21-440 76 90

Romania

GRUNDFOS Pompe România SRL
Bd. Biruintei, nr 103
Pantelimon county Ilfov
Phone: +40 21 200 4100
Telefax: +40 21 200 4101
E-mail: romania@grundfos.ro

Russia

ООО Грундфос
Россия, 109544 Москва, ул. Школьная 39
Тел. (+7) 495 737 30 00, 564 88 00
Факс (+7) 495 737 75 36, 564 88 11
E-mail grundfos.moscow@grundfos.com

Serbia

GRUNDFOS Predstavništvo Beograd
Dr. Milutina Ivkovića 2a/29
YU-11000 Beograd
Phone: +381 11 26 47 877 / 11 26 47 496
Telefax: +381 11 26 48 340

Singapore

GRUNDFOS (Singapore) Pte. Ltd.
25 Jalan Tukang
Singapore 619264
Phone: +65-6681 9688
Telefax: +65-6681 9689

Slovenia

GRUNDFOS d.o.o.
Štandrova 8b, SI-1231 Ljubljana-Črnuče
Phone: +386 1 568 0610
Telefax: +386 1 568 0619
E-mail: slovenia@grundfos.si

South Africa

GRUNDFOS (PTY) LTD
Corner Mountjoy and George Allen Roads
Wilbart Ext. 2
Bedfordview 2008
Phone: (+27) 11 579 4800
Fax: (+27) 11 455 6066
E-mail: lsmart@grundfos.com

Spain

Bombas GRUNDFOS España S.A.
Camino de la Fuentesilla, s/n
E-28110 Algete (Madrid)
Tel.: +34-91-848 8800
Telefax: +34-91-628 0465

Sweden

GRUNDFOS AB
Box 333 (Lunnagårdsgatan 6)
431 24 Mölndal
Tel.: +46 31 332 23 000
Telefax: +46 31 331 94 60

Switzerland

GRUNDFOS Pumpen AG
Bruggacherstrasse 10
CH-8117 Fällanden/ZH
Tel.: +41-1-806 8111
Telefax: +41-1-806 8115

Taiwan

GRUNDFOS Pumps (Taiwan) Ltd.
7 Floor, 219 Min-Chuan Road
Taichung, Taiwan, R.O.C.
Phone: +886-4-2305 0868
Telefax: +886-4-2305 0878

Thailand

GRUNDFOS (Thailand) Ltd.
92 Chaloen Phrakiat Rama 9 Road,
Dokmai, Pravej, Bangkok 10250
Phone: +66-2-725 8999
Telefax: +66-2-725 8998

Turkey

GRUNDFOS POMPA San. ve Tic. Ltd. Sti.
Gebze Organize Sanayi Bölgesi
Ihsan dede Caddesi,
2. yol 200. Sokak No. 204
41490 Gebze/ Kocaeli
Phone: +90 - 262-679 7979
Telefax: +90 - 262-679 7905
E-mail: satis@grundfos.com

Ukraine

ТОВ ГРУНДФОС УКРАЇНА
01010 Київ, Вул. Московська 8б,
Тел.: (+38 044) 390 40 50
Факс.: (+38 044) 390 40 59
E-mail: ukraine@grundfos.com

United Arab Emirates

GRUNDFOS Gulf Distribution
P.O. Box 16768
Jebel Ali Free Zone
Dubai
Phone: +971 4 8815 166
Telefax: +971 4 8815 136

United Kingdom

GRUNDFOS Pumps Ltd.
Grovebury Road
Leighton Buzzard/Beds. LU7 8TL
Phone: +44-1525-850000
Telefax: +44-1525-850011

U.S.A.

GRUNDFOS Pumps Corporation
17100 West 118th Terrace
Olathe, Kansas 66061
Phone: +1-913-227-3400
Telefax: +1-913-227-3500

Uzbekistan

Представительство ГРУНДФОС в Ташкенте
700000 Ташкент ул. Усмана Носира 1-й тулик 5
Телефон: (3712) 55-68-15
Факс: (3712) 53-36-35

Revised 27.04.2012

98354151 1012
ECM: 1100445

The name Grundfos, the Grundfos logo, and the payoff **be think innovate** are registered trademarks owned by Grundfos Holding A/S or Grundfos A/S, Denmark. All rights reserved worldwide.